



OAKFIELD



Rufus Close, Lewes
Asking Price £620,000



SUMMARY

An Attractive Georgian-Style Home in the Sought-After Wallands Area – Offered with No Chain

Set within a peaceful residential close in the ever-popular Wallands area of Lewes, this elegant Georgian-style terrace offers spacious, light-filled accommodation and the perfect setting for family life. With its well-balanced layout, generous gardens, and desirable location, this home is ready to move straight into – and is being sold with the added benefit of no onward chain.

The ground floor features an inviting entrance hallway leading to a bright sitting room, complete with a large feature window and fireplace surround. The separate dining room enjoys direct access to the rear garden, making it an ideal space for entertaining, while the kitchen provides plenty of scope for modernisation.

Upstairs, three bedrooms are arranged around a central landing, with the principal bedroom enjoying its own private balcony. A family bathroom and separate WC complete the first-floor accommodation.

Additional benefits include a very useful single garage en-bloc just a short walk from the house, gas central heating, double-glazed windows, and the property is complemented by both front and rear gardens, with the rear offering a



A photograph of a dining room. In the center is a dark wood dining table with a semi-circular end, surrounded by four matching wooden chairs with patterned upholstered seats. A large, ornate wooden sideboard stands against the left wall, topped with various decorative items and a small lamp. A large, multi-paned stained glass pendant light hangs from the ceiling. The walls are a light beige color, adorned with several framed pictures and a small round clock. A large window with patterned curtains is on the right, offering a view of greenery outside. A white door is visible on the far right. The floor is covered in a light-colored carpet.

A photograph of a dining room. In the center is a dark wood dining table with a semi-circular end, surrounded by four wooden chairs with patterned seats. To the left is a large, dark wood sideboard with drawers and cabinets, topped with various decorative items. A lamp with a patterned shade sits on the sideboard. Above the table hangs a large, ornate stained glass pendant light. The walls are a light beige color, decorated with several framed pictures and a small round clock. A large window with patterned curtains is on the right, offering a view of greenery outside. A white door is visible on the far right. The floor is covered in a light-colored carpet.

A photograph of a dining room. In the center is a dark wood dining table with a semi-circular end, surrounded by four wooden chairs with patterned upholstered seats. To the left is a large, dark wood sideboard with drawers and cabinets, topped with various decorative items including a lamp and framed pictures. A large, ornate stained glass pendant light hangs above the table. The walls are a light beige color, decorated with several framed artworks and a small round clock. A white door is visible on the right, and a window with patterned curtains is in the background. The floor is covered with a light-colored carpet.

Sitting Room

15'3 x 12'6

Kitchen

9'11 x 8'4

Dining Area

14'1 x 9'3

Bedroom

13'5 x 12'2

Bedroom

12'2 x 10'0

Bedroom

10'2 x 6'6

Council Tax Band - E £3,211 per annum

Single Garage en-bloc













INFORMATION

Tenure

Freehold

Local Authority

Lewes District Council

Council Tax Band

E

Opening Hours

Monday to Friday	9.00am - 5.30pm
Saturday	9.00am - 4.00pm

Viewings

Please contact us on 01273 474101 if you wish to arrange a viewing appointment for this property or require further information.

Area Map



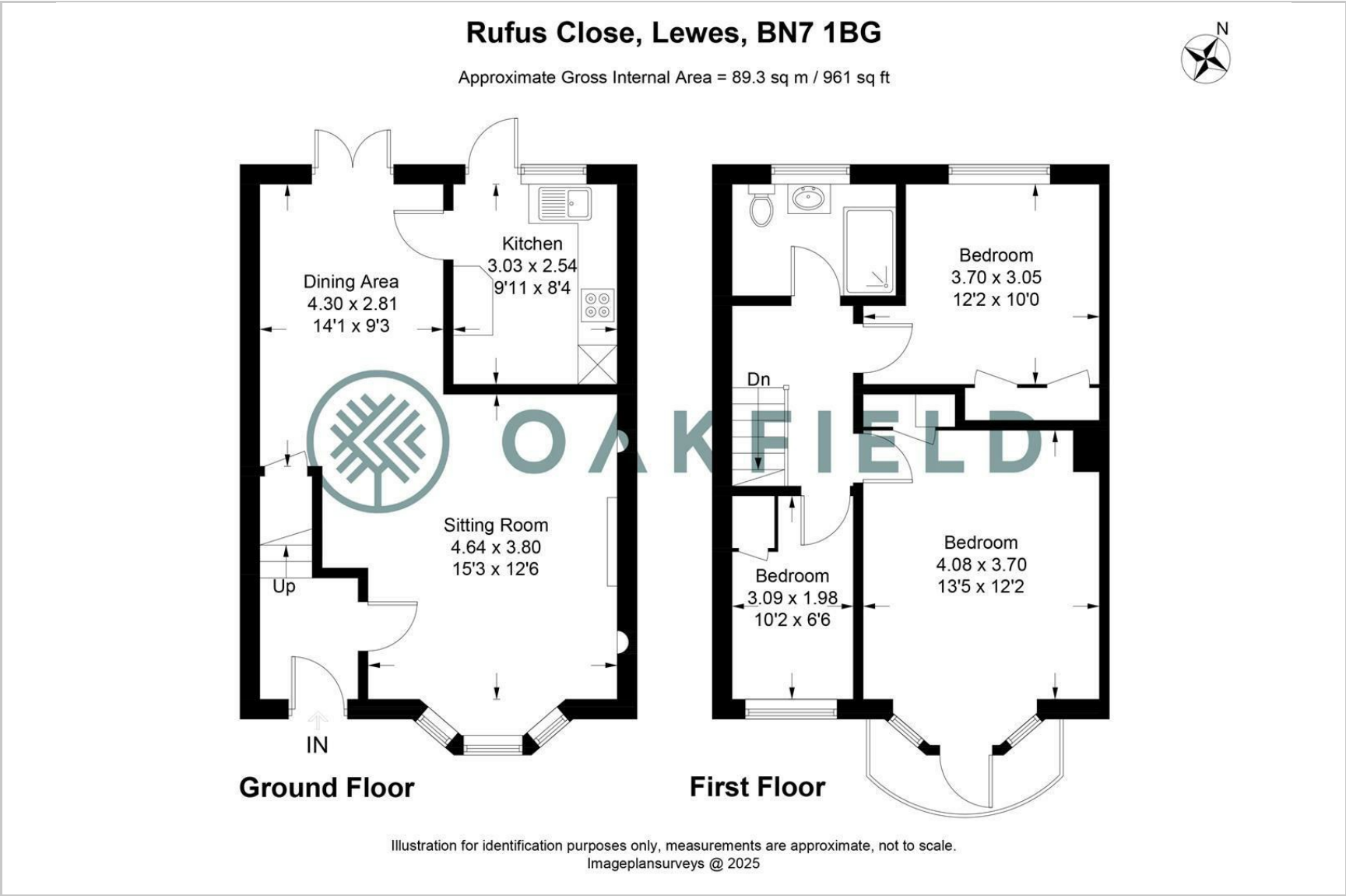

These particulars, whilst believed to be accurate are set out as a general outline only for guidance and do not constitute any part of an offer or contract. Intending purchasers should not rely on them as statements of representation of fact, but must satisfy themselves by inspection or otherwise as to their accuracy. No person in this firms employment has the authority to make or give any representation or warranty in respect of the property.